



Please Read



WORKSPACE PRODUCTIVITY TOOLS

Split Clamp Assembly (If Included)

Step 1

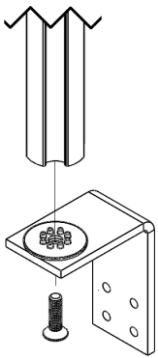

Step 2

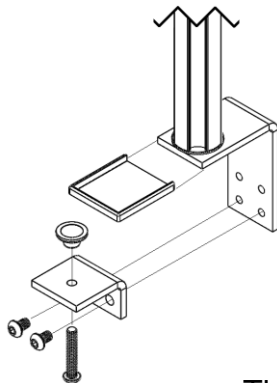

Step 3

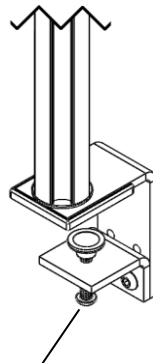

Tighten M8 screw

Clamp width guide

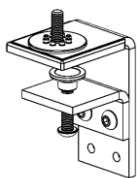

<25mm

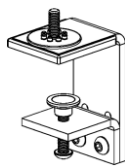

26 - 47mm

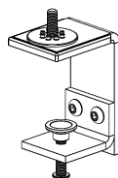

48 - 69mm

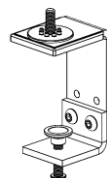

70 - 93mm

Step 1: Attaching pole to clamp

- Using the M8 x 30 countersunk screw, attach the L part of the clamp to the pole
- Tighten the screw firmly.

Step 2: Assembling the clamp

- Attach the small L to the large L using 2 x M8 x 12 button head screws. Position as per clamp width guide and rest in designed position.
- When securing to the desk, place the rubber pad underneath to protect the surface.
- Screw the M8 x 40 button head screw through the small L and place the clamp foot on top.

Step 3: Securing to the desk

- Using the supplied hex key, tighten the M8 button head clamp screw.

Kidney Grommet Clamp Assembly (If Included)

Step 1

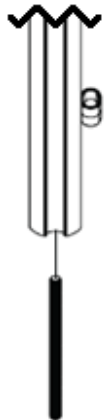

Step 2



Step 3

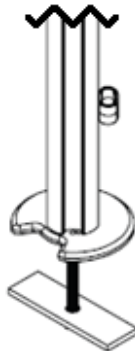

Hole size guide



Ø8.5mm Min
Ø50mm Max

Step 1: Attaching pole to rod

- Screw the M8 x 122mm threaded rod into the base of the pole.
- Tighten the threaded rod firmly.

Step 2: Assembling the clamp

- If required, drill a hole in the desk as per hole size guide.
- Place the kidney grommet against the pole base, then put the rod through the desk hole.
- Place the flat bar against the underside of the desk and wind on the nut.

Step 3: Securing to the desk

- Use a spanner to tighten the nut on the underside and ensure assembly is secure.

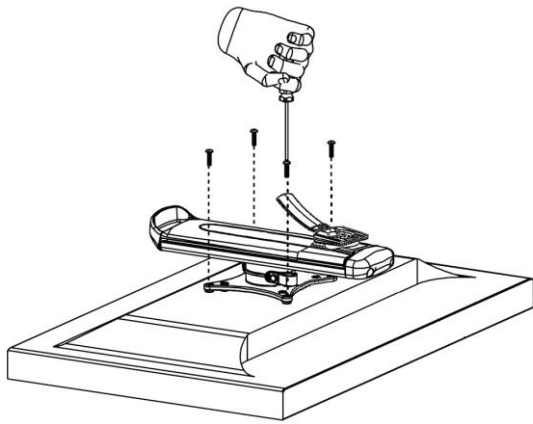

Step 1: Attaching the monitor

- Place monitor face down on a clean surface.
- Attach 4 x M4 x 16 pan pozi screws (supplied) to BladeRunner™ Vesa

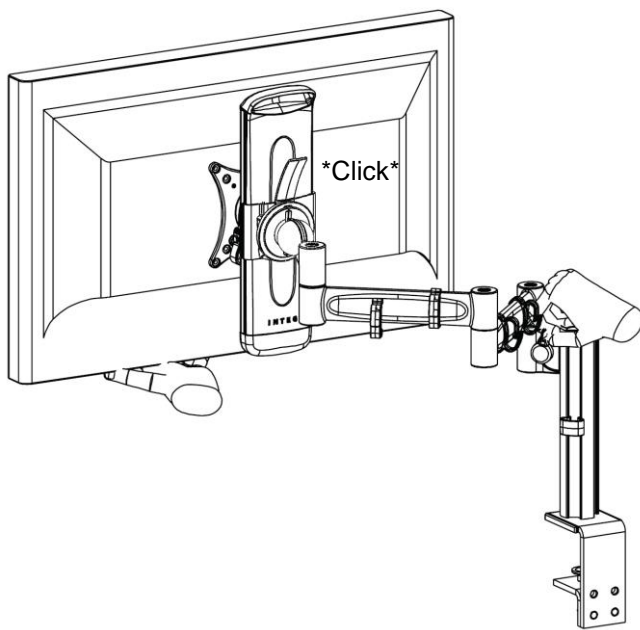

Step 2: Attaching the arms

- Click the monitor/VESA into the arm
- Turn wedge knob anti clockwise until fully open.
- Insert loose flap of wedge into slot first.
- Once the arm is at the desired height, turn the knob clockwise to tighten.

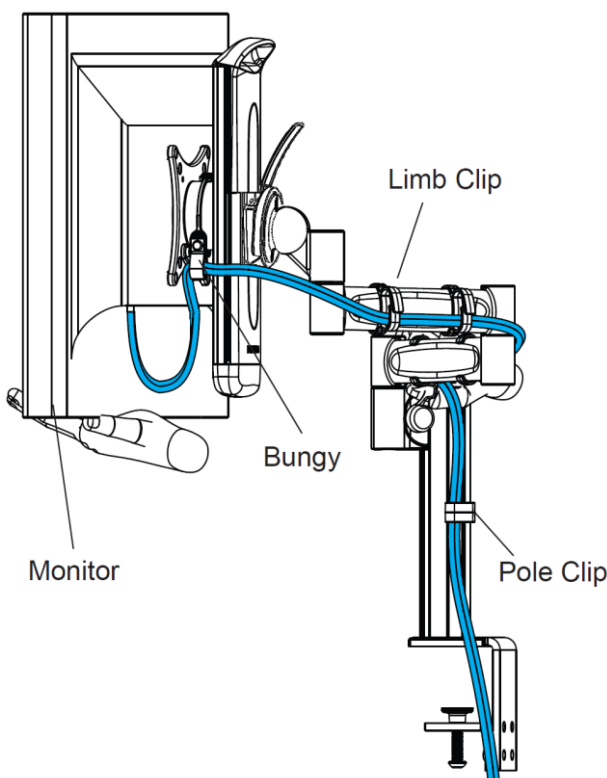
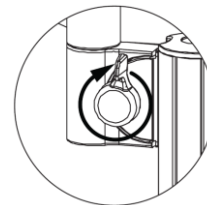

Step 3: Attaching cables

- Cables from the monitor go through the Bungy cord
- Through the Limb cable clips
- Through the Pole clips

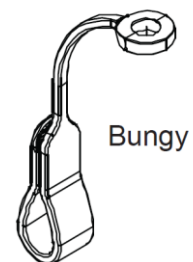

Integ

Integ, Proudly made by Modtec Industries

Modtec Industries Limited
Modtec Industries Australia PTY Limited ABN 22 997 983 407
Ph. +64 9 426 6380 Ph.1800 681 327 (Aust toll free)
Fax. +64 9 426 9449
20 Curley Ave Silverdale, Auckland 0932, New Zealand
P.O. Box 14 Silverdale, Auckland 0944, New Zealand
www.integ.it
Email: info@integinternational.com

Want to interact with us differently?
Join us on Facebook or follow us on Twitter (@Integit).

